

Preparation of Mid-Section.

Before you start, make sure all parts shown are included with your product.

Parts may appear slightly different than illustrated.

Parts List

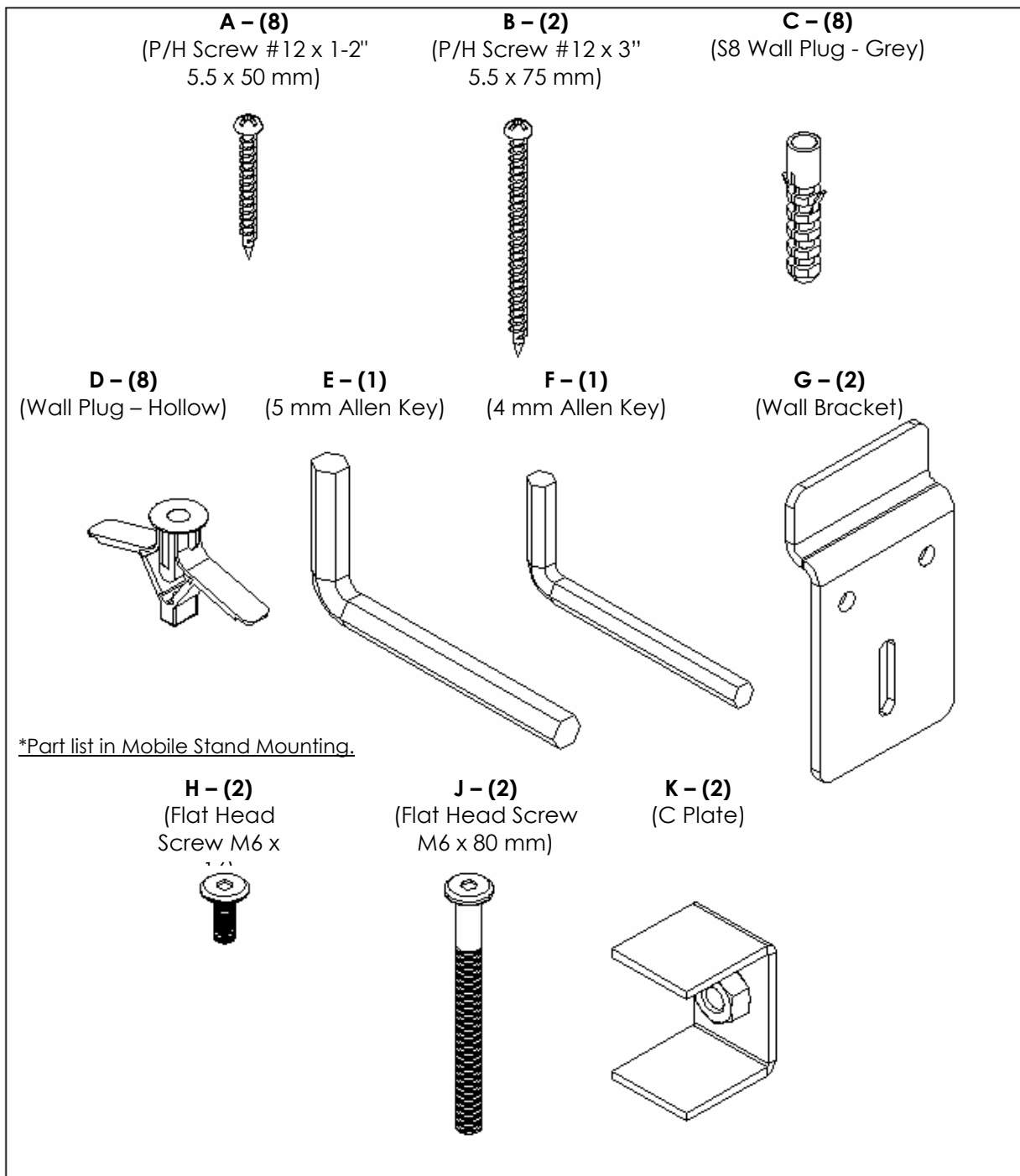

Figure 1.1

- 1) Plug in the provided power cable.
Use the controller to move the front frame holder upwards.
*(Do not push or pull the front frame).

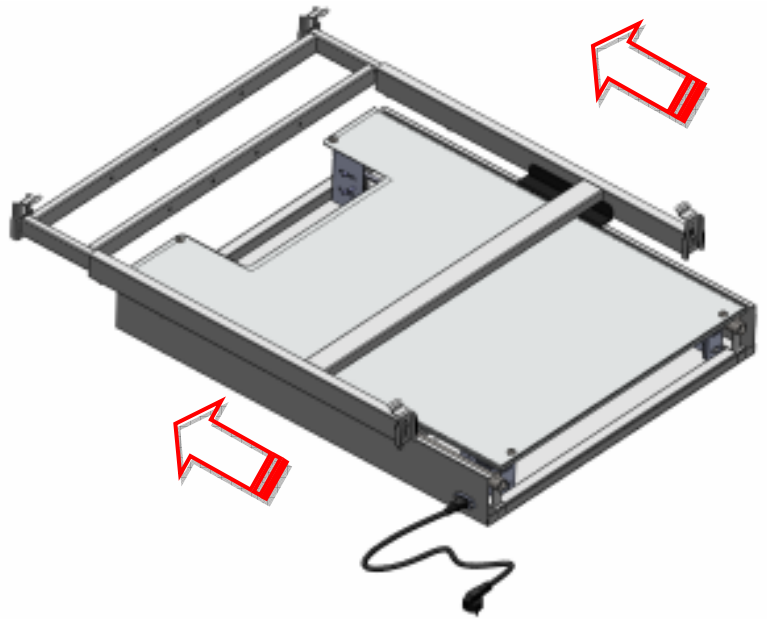

Figure 2.1

- 2) Remove the four screws from the Front Cover using the Allen Key (E).
Remove the Front Cover.

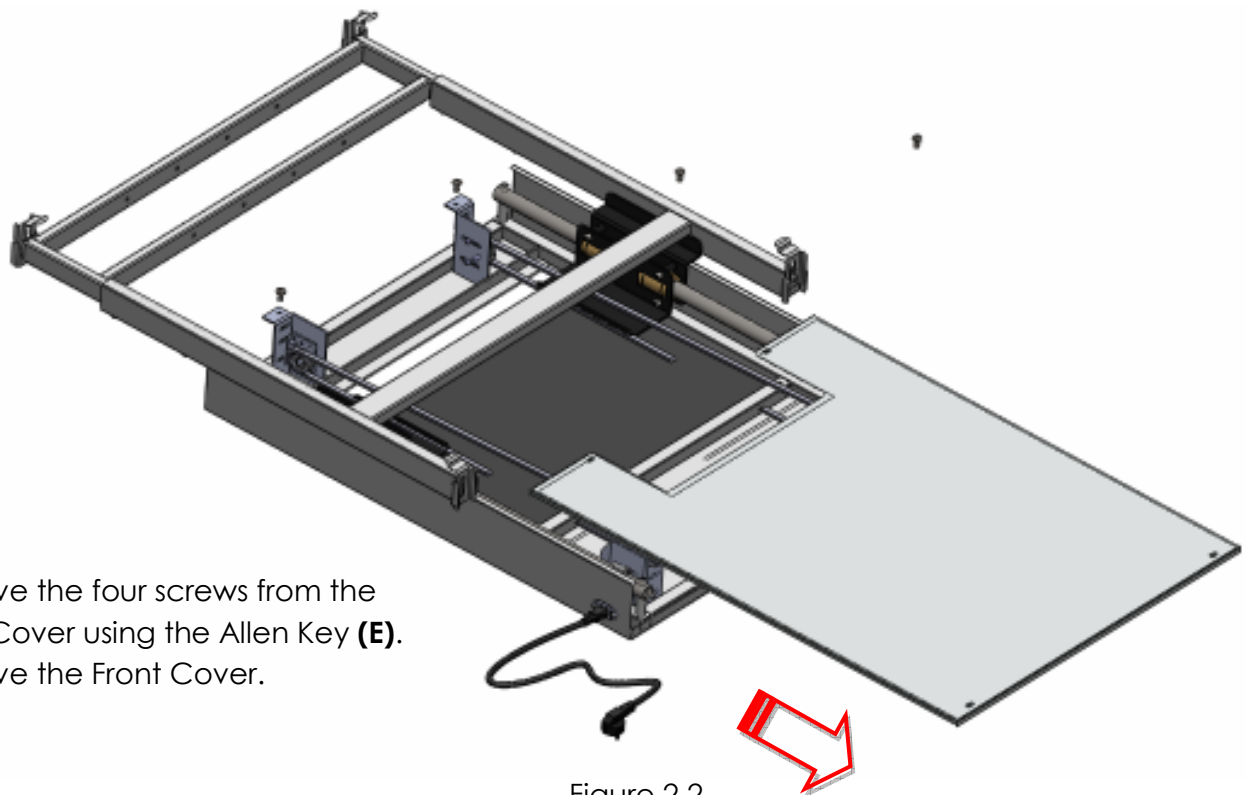

Figure 2.2

Note:

- >> For Mobile Stand, proceed to page 3.
- >> For Wall Mount, proceed to page 8.
- >> For Projector Cable Guide, proceed to page 15.

Ensure the Mobile Stand is assembled.
Check the mounting holes on leg (see figure 3.2 + 3.3 + 3.4).

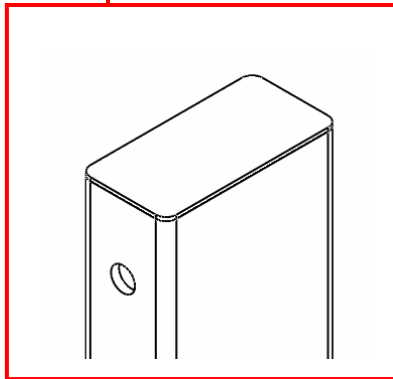
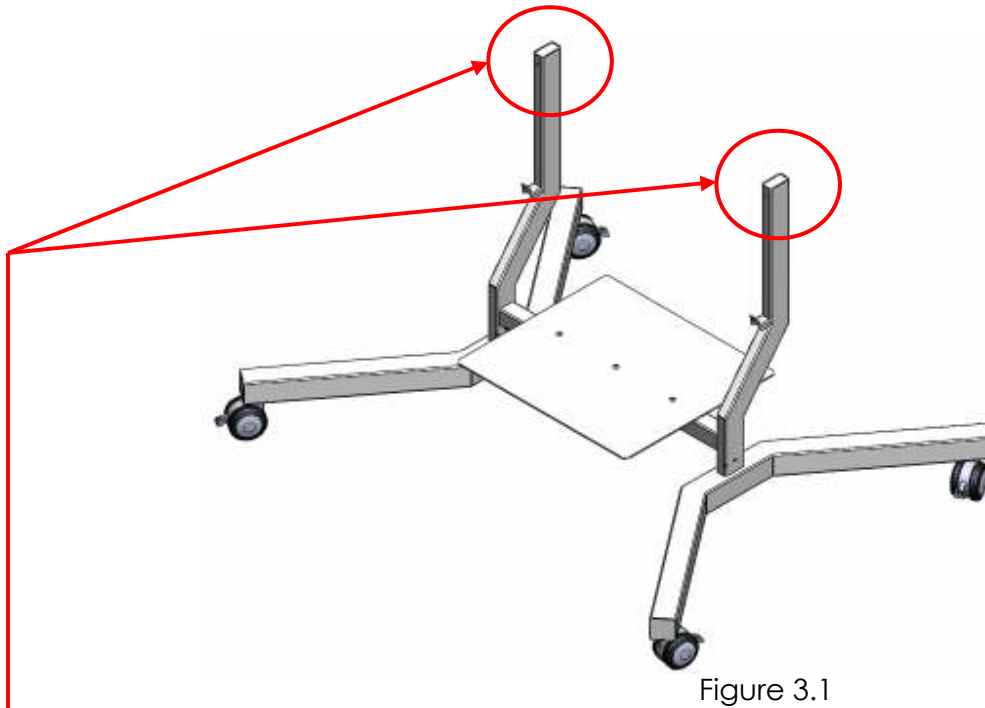

Figure 3.2
Version A
If Leg Base has 1 hole
>> proceed to page 4.

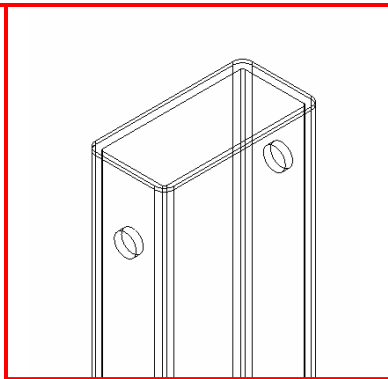

Figure 3.3
Version B
If Leg Base has 2 holes:
front & back
>> proceed to page 5.

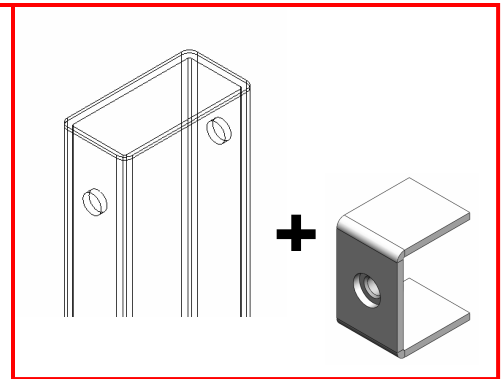

Figure 3.4
Version C
If Leg Base has 2 holes
+ C Plate
>> proceed to page 6.

Mid-Section mounting to Mobile Stand with 1 Hole.

Parts required for assembly
1) Flat Head Screw M6 x 16 **(H)**
2) Allen Key **(F)**

- 1) Make sure that the front frame is adjusted upwards until two mounting holes are visible (see figure 4.2). When mounting the Mid-Section to the Mobile Stand make sure the Mobile Stand Frame sits properly on the Mobile Stand Stoppers

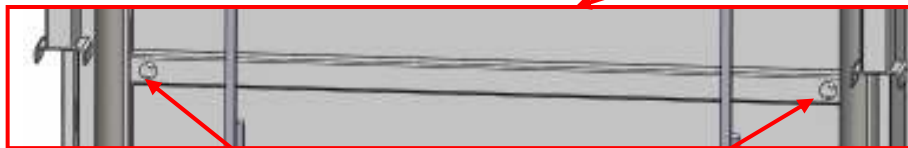
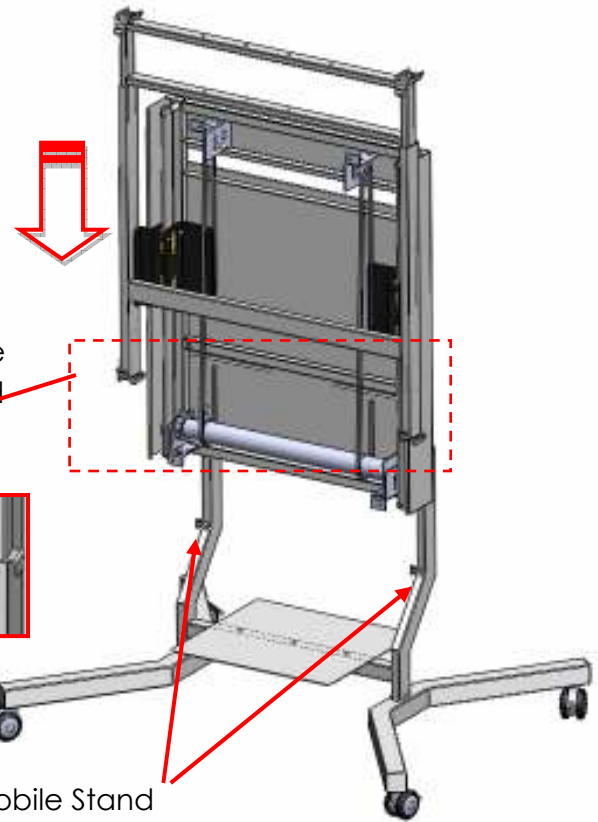

Figure 4.2



Mobile Stand
Stopper

Figure 4.1

- 2) Screw and tighten two screws **(H)** towards Mid-Section with Allen Key **(F)**. (See figure 4.3)

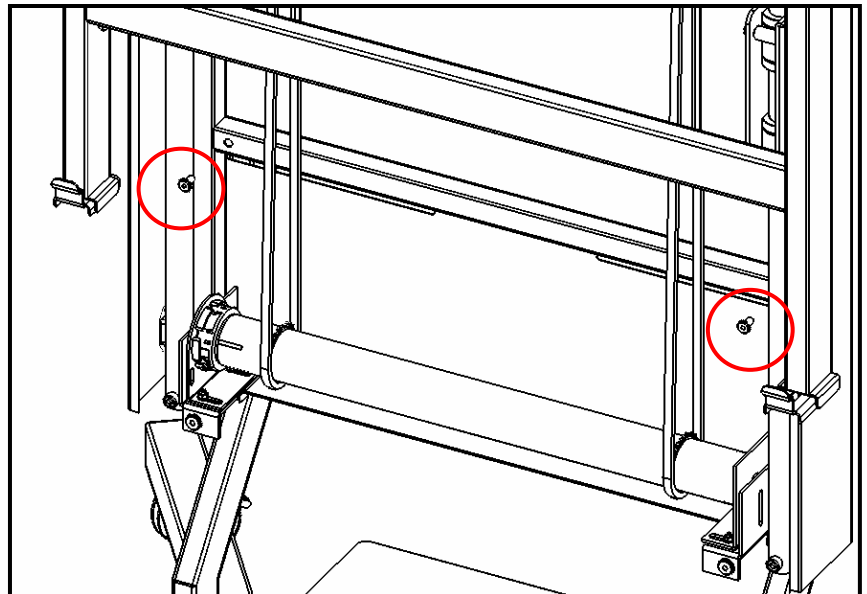

Figure 4.3

Note:

>> For reinstalling Front Cover, proceed to page 7.

Mid-Section mounting to Mobile Stand **WITHOUT** C Plate **(K)**.

- Parts required for assembly
- 1) Flat Head Screw M6 x 80 **(J)**
 - 2) Allen Key **(F)**

- 1) Make sure the Mid-Section sits properly on the Mobile Stand Stoppers as shown on figure 5.1.

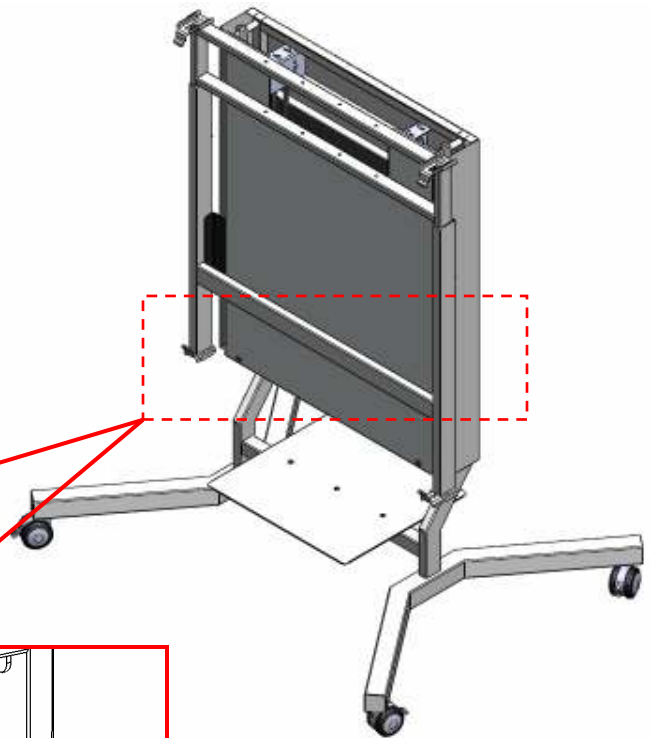
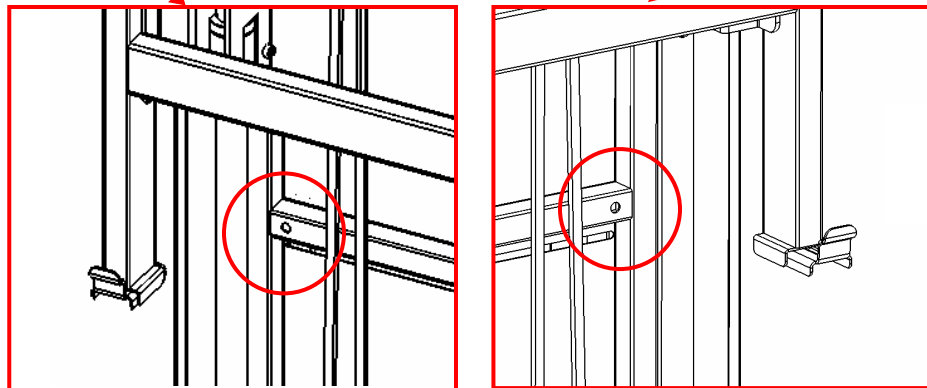

Figure 5.1



- 2) Insert two screws **(J)** from rear of Mobile Stand and tighten securely with Allen Key **(F)** as shown on figure 5.2.

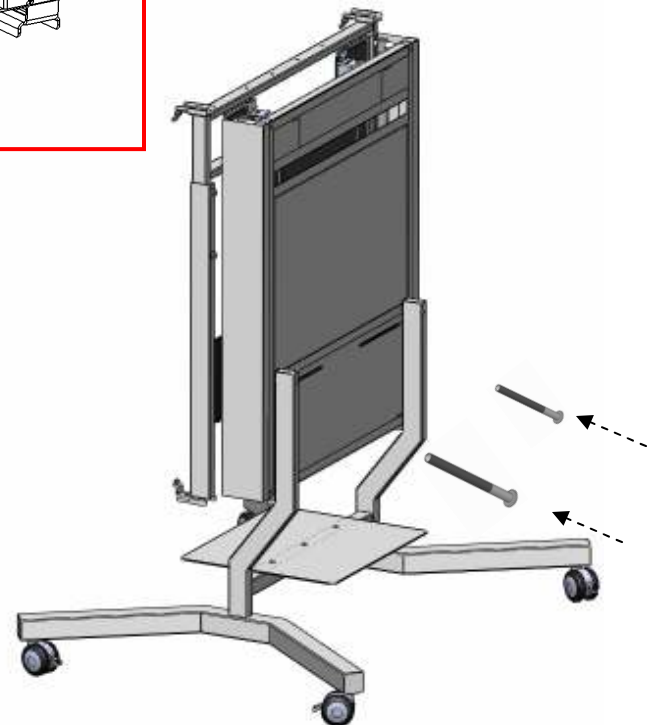

Figure 5.2

Note:

>> For reinstalling Front Cover, proceed to page 7.

Mid-Section mounting to Mobile Stand **WITH** C Plate **(K)**.

Parts required for assembly

- 1) Two C Plate **(K)**
- 2) Flat Head Screw M6 x 80 **(J)**
- 3) Allen Key **(F)**

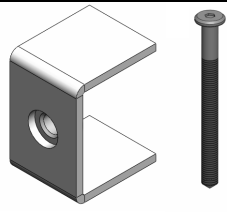

- 1) Make sure that the front frame is adjusted upwards until two mounting holes are visible (see figure 6.2). When mounting the Mid-Section to the Mobile Stand make sure the Mobile Stand Frame sits properly on the Mobile Stand Stoppers

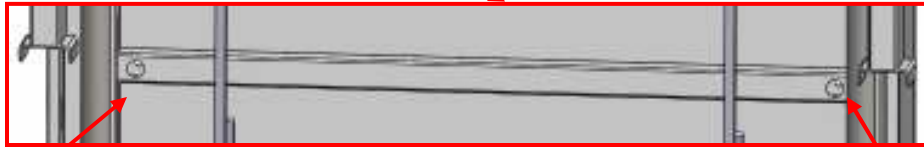
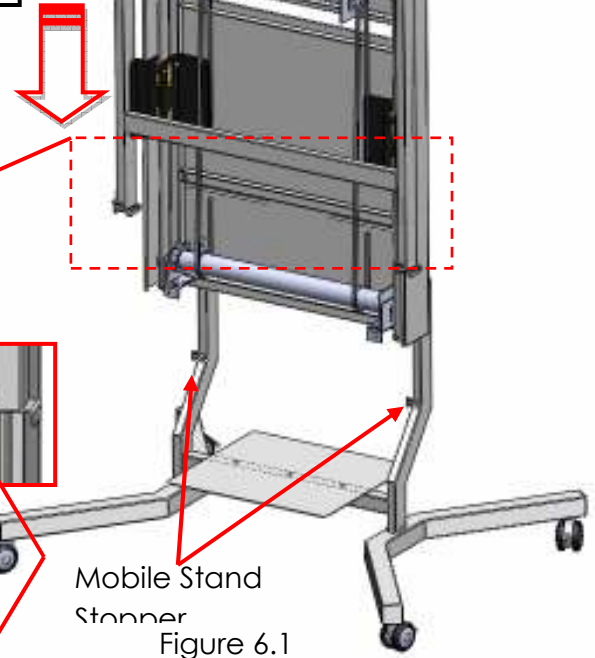

Figure 6.2

- 2) Place the C Plates **(K)** (see figure 6.3 & 6.4).

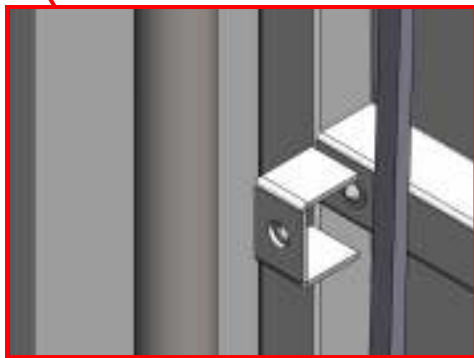

Figure 6.3

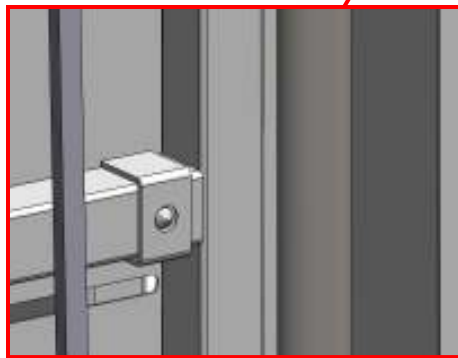

Figure 6.4

- 3) Insert two screws **(J)** from rear of Mobile Stand. Make sure screws securely tighten to C plate **(K)**.

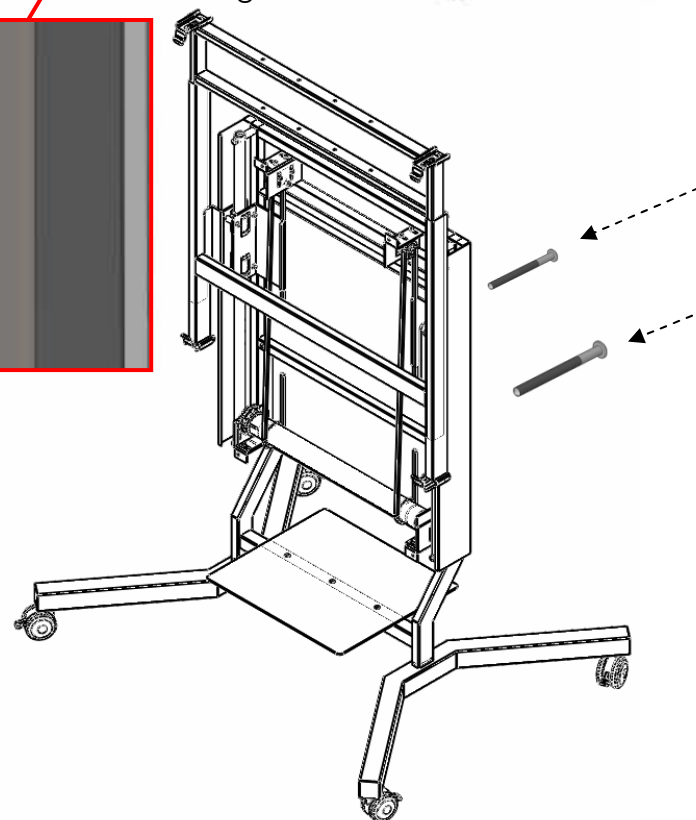

Figure 6.5

Note:

>> For reinstalling Front Cover, proceed to page 7.

Front Cover Re-installation, after Mobile Stand mounting .
Versions A + B + C

- 1) Reinstall the Front cover to the Mid-Section and tighten the four Screws using the Allen Key **(E)**
- 2) Assembly Ready.

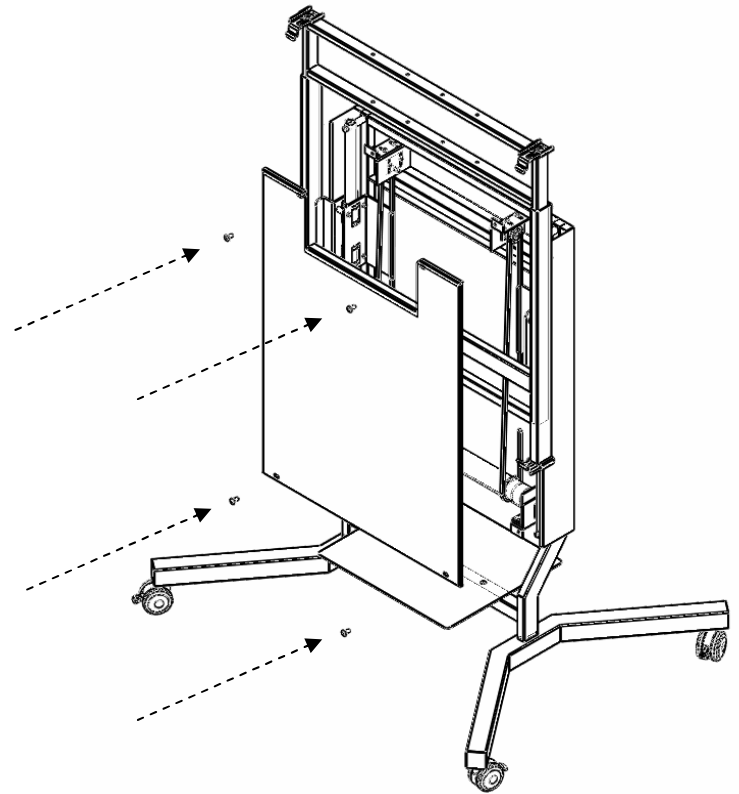

Figure 7.1

Mid-Section mounting to Hollow Wall / Metal Stud Wall / Wooden Stud Wall

Note:

>> For Solid Wall, proceed to page 9.

- 1) Use a Stud-Finder to find the stud positions, align the template accordingly
- 2) Mark the center of the Mid-Section onto the wall using the provided template.

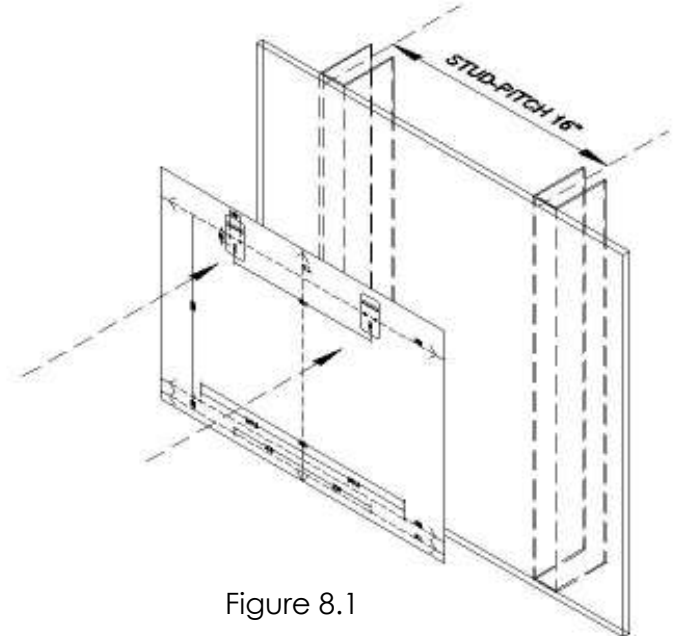

Figure 8.1

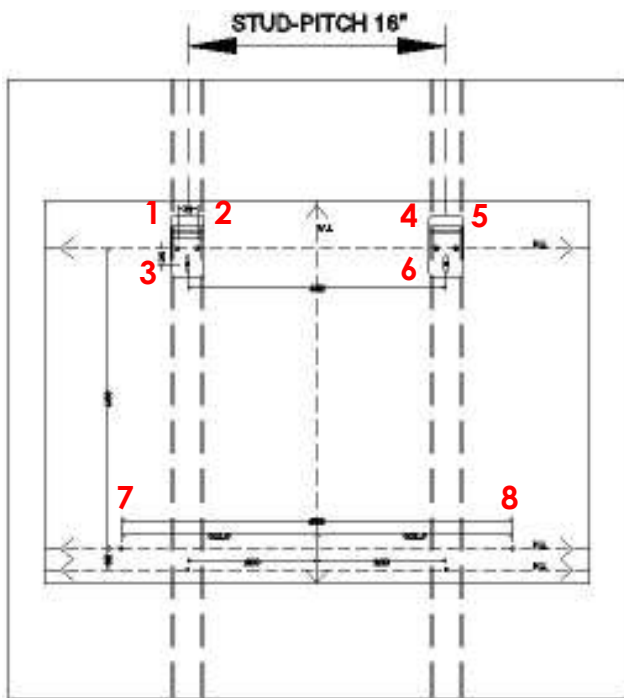

Figure 8.2

- 3) For Wooden Studs drill eight diameter **3.0 x 20 mm** deep holes >>> go to step 6
- 4) For Hollow Wall and Steel Studs
Drill eight round 9.0 mm holes.
Note:
For hollow wall with 16" pitch stud, use pitch distances 400 mm bottom hole on template.

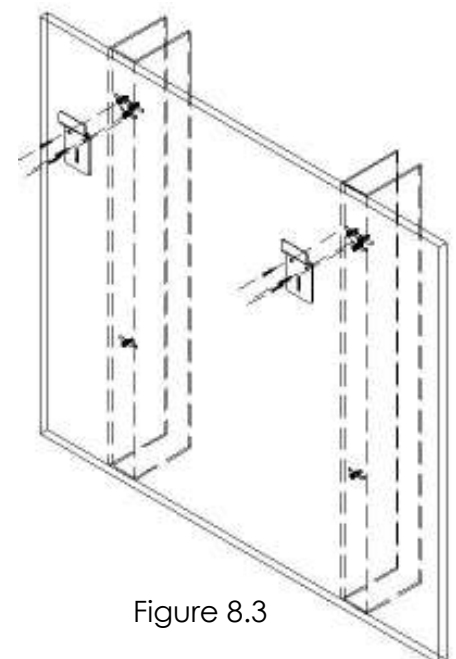

Figure 8.3

- 5) Insert the eight provided Wall Plugs (**D**) into the holes.
- 6) Secure the Wall Bracket (**G**) to the wall by securely tightening six screws (**A**) (see figure 8.3).

>> Proceed to page 10.

Mid-Section mounting to Solid Wall

- 1) Mark the center of the **Mid-Section** using the provided template onto

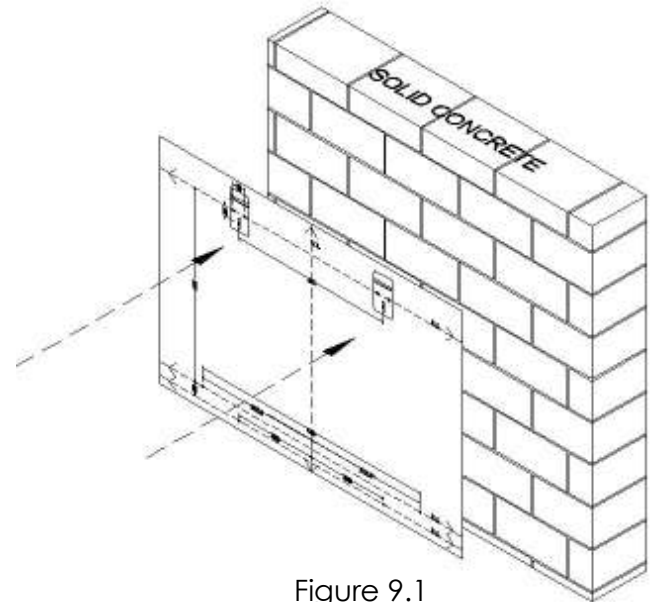

Figure 9.1

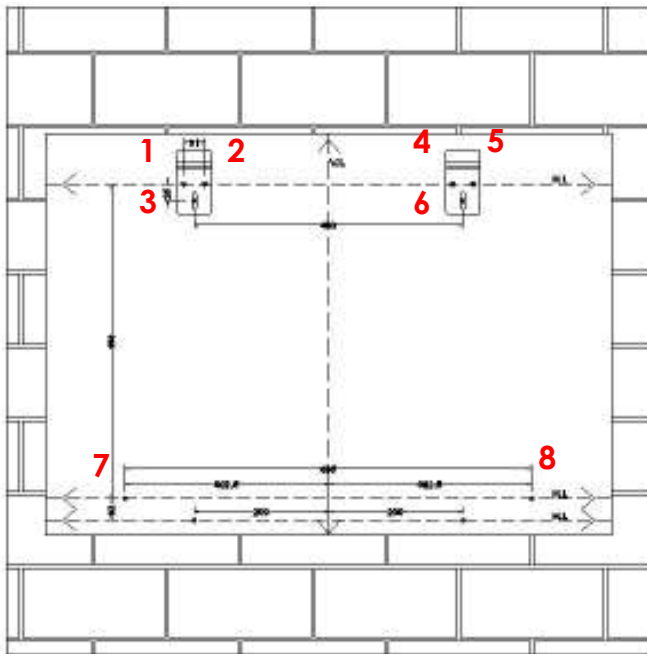

Figure 9.2

- 2) Drill eight diameter **8.0 x 50 mm** deep holes.

Note: For solid wall, use pitch distances 600 mm or 400 mm, for the two bottom holes.

For pitch 600 mm, use two screws **(B)**.

- 3) Insert the provided Wall Plugs **(C)** into the holes.
- 4) Secure the Wall Bracket **(G)** to the wall by securely tightening six screws **(A)** (see figure 9.3).

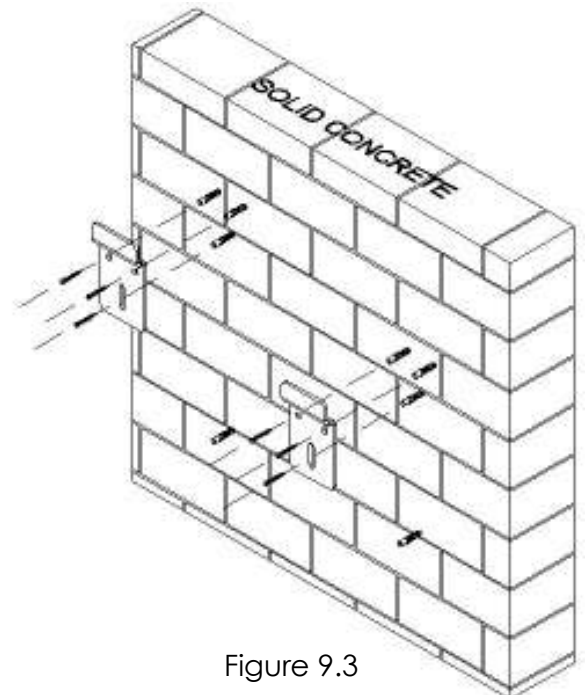

Figure 9.3

>> Proceed to page 10.

- 1) Stick the four Foam Pads to all corners (see figure 10.1).

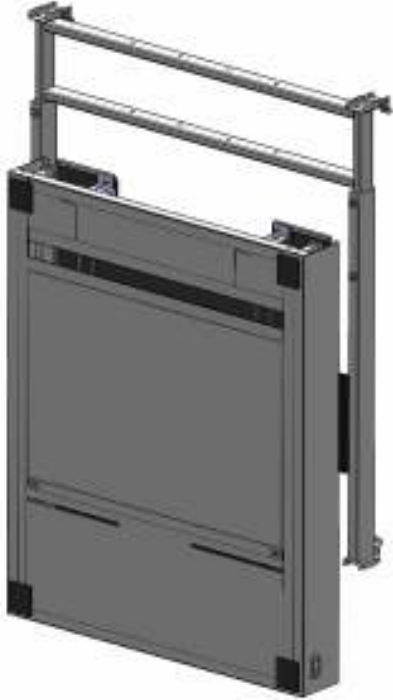

Figure 10.1

- 2) Hook the Mid-Section onto the Wall Brackets (G).

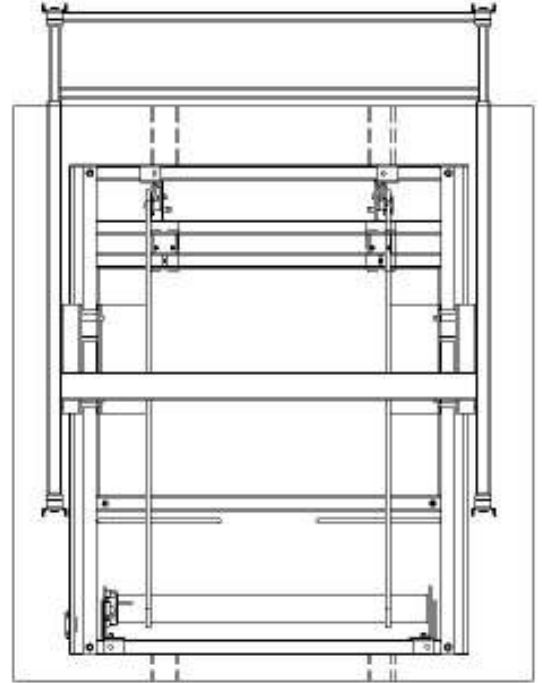

Figure 10.2

- 3) Secure the Mid-Section to the wall by tightening two screws (A) into the bottom holes.

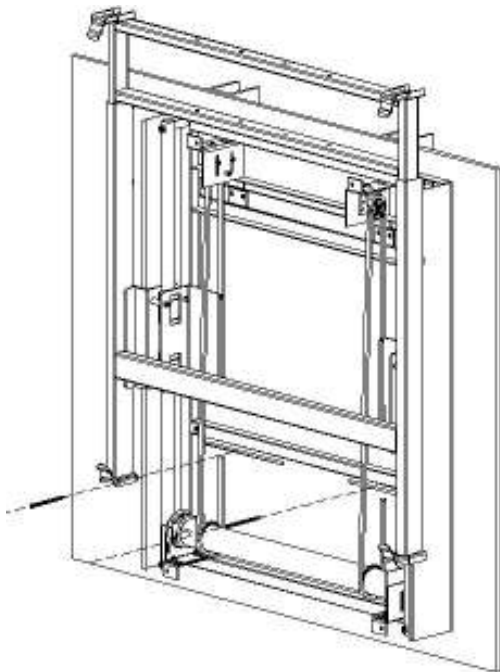

Figure 10.3

- 4) Reinstall the Front cover to the Mid-Section and tighten the four Screws using the Allen Key (E).
- 5) Assembly ready.

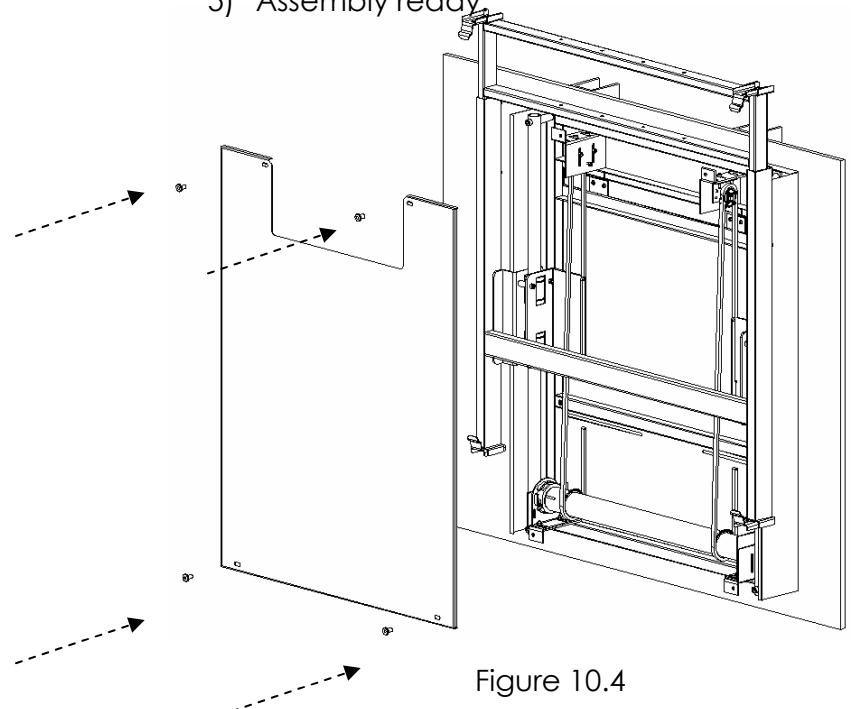

Figure 10.4

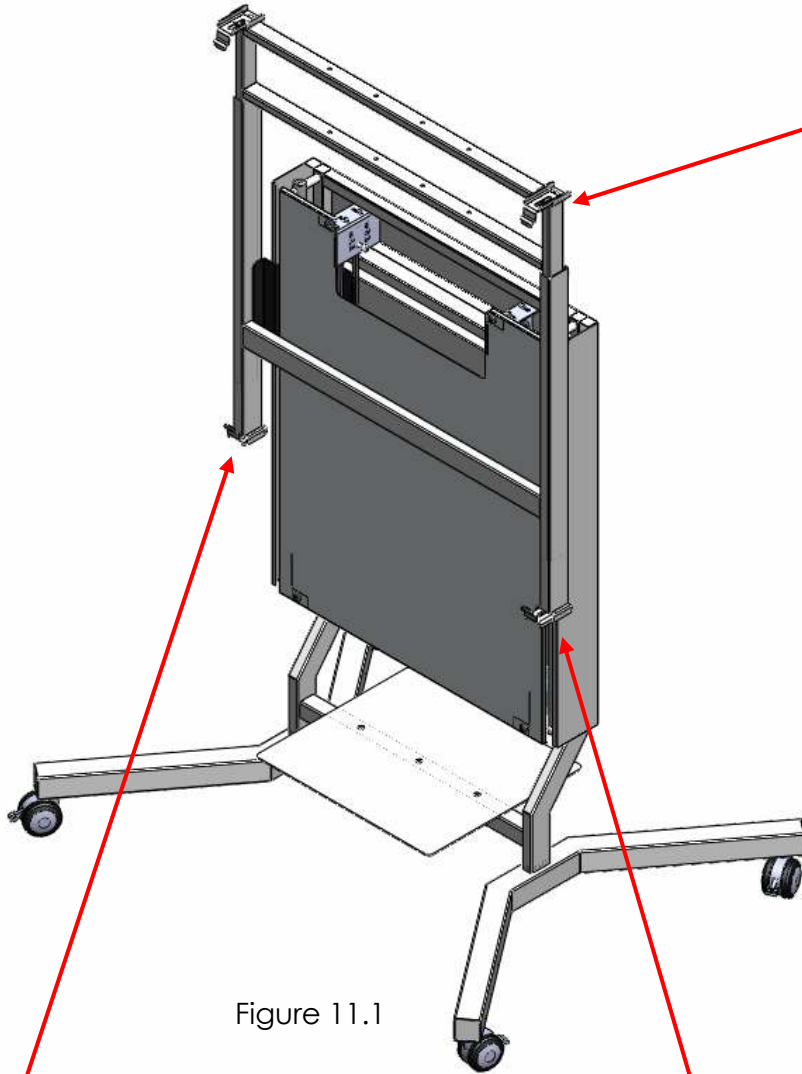
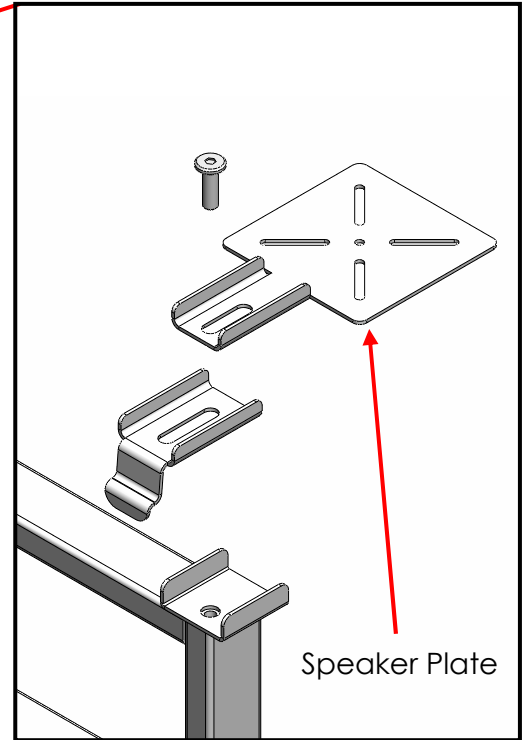
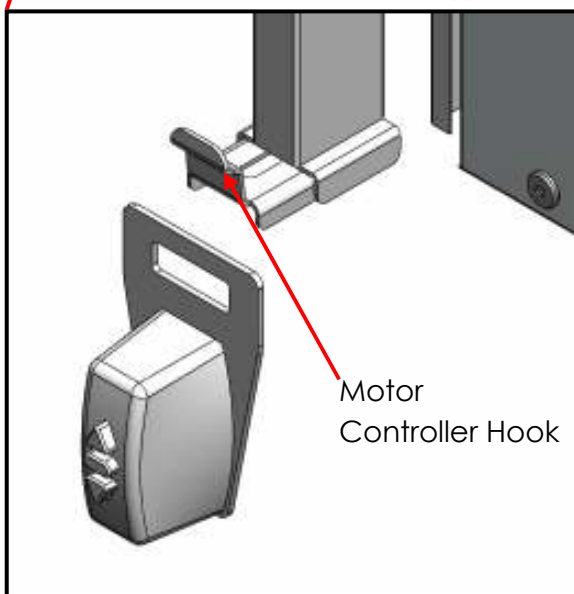

Figure 11.1



Speaker Plate

Remove the screw with the Allen Key **(E)**.



Motor
Controller Hook

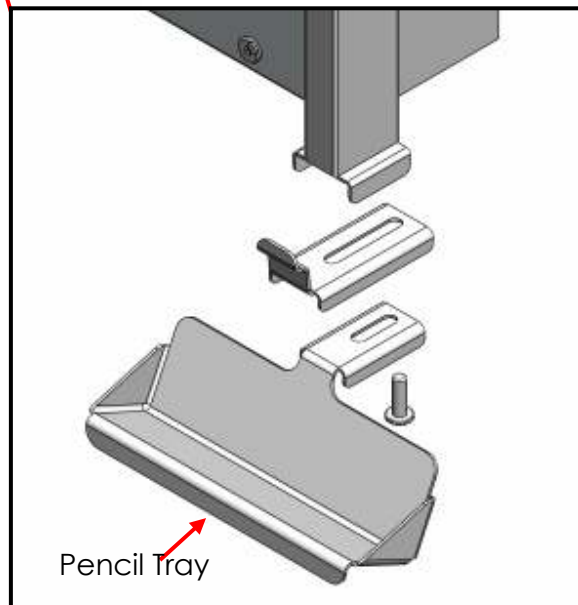

Pencil Tray

Remove the screw with the Allen Key **(E)**.

Preparation of Add-on Sliders.

Before you begin, make sure all parts shown are included with your product.

Parts may appear slightly different than illustrated.

Parts List

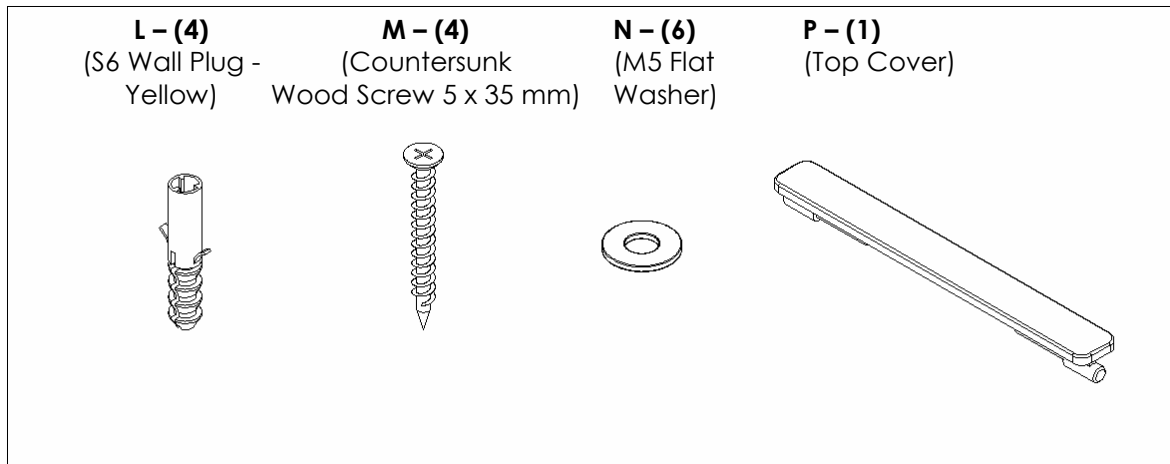

Figure 12.1

- 1) Ensure the **Mid-Section** is hooked onto the wall.
- 2) Attach the **Slider Plate** and **Slider Bracket** (see figure 12.2) onto the Clamp Plate (see figure 12.3). Unscrew and reattach the Flat Head Screws to do so.
- 3) Mark the centers of the Slider Plate's **Wall Holes** (see figure 13.1) onto the wall. Make sure the sliders plate is sitting on the Mid Section.

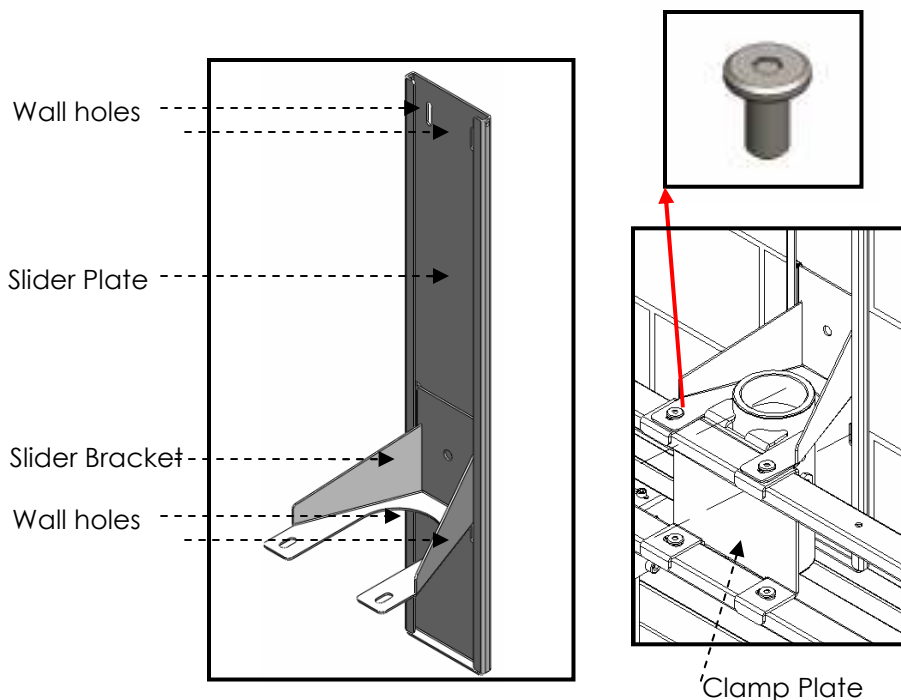

Figure 12.2

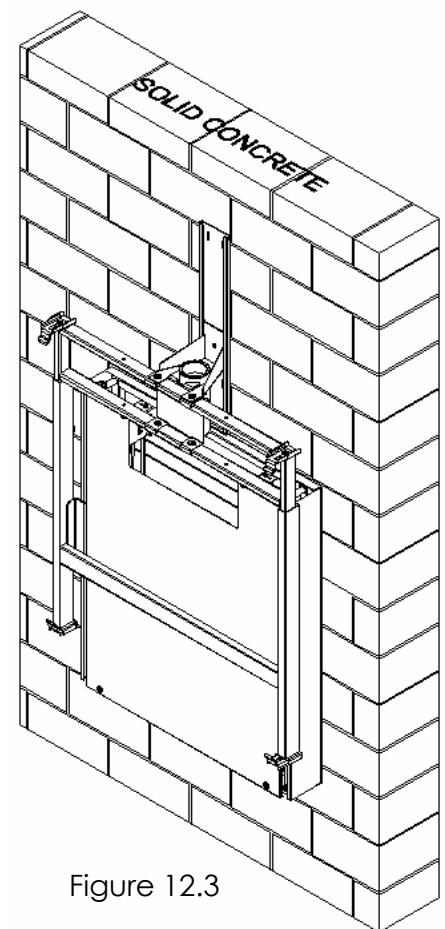

Figure 12.3

- 4) Remove the Slider Plate and Slider Bracket (figure 13.1).
- 5) Drill four diameter 6.0 mm x 40 mm deep holes
- 6) Insert the four provided Wall Plugs (**L**) to hole.
- 7) Fix the Slider Plate to the wall and tighten securely with four screws (**M**) as shown on figure 13.3.

Note: If there's a gap between wall and slider plate, use provided flat washer (**N**) as spacer.

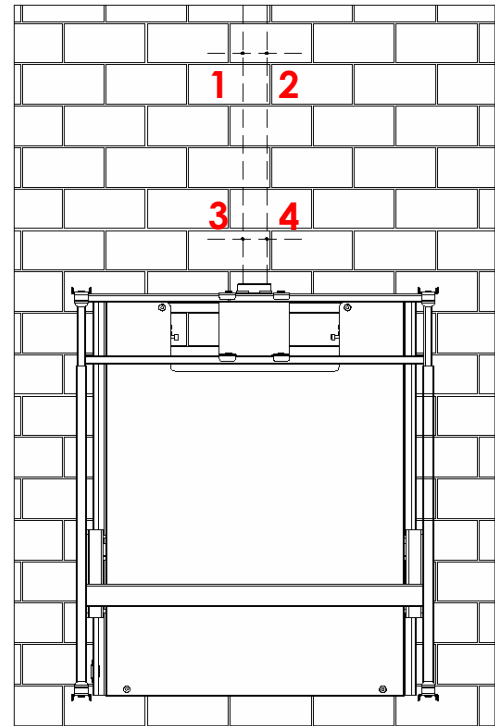

Figure 13.1

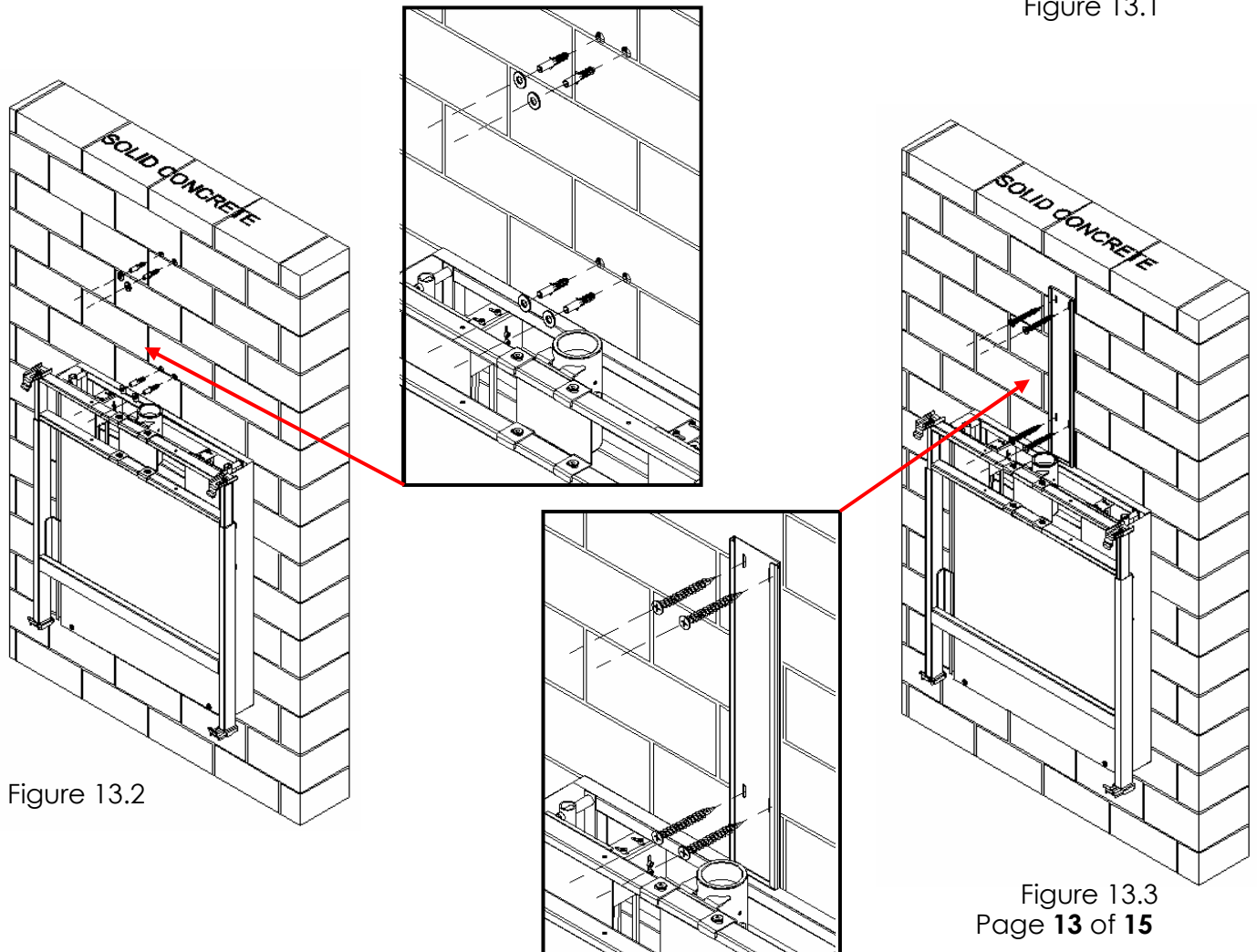

Figure 13.2

Figure 13.3
Page 13 of 15

- 8) Slot the Slider Bracket into the Slider Plate.
- 9) Click the Top Cover (P) into the top opening of Slider Plate.
- 10) Move the Slider Bracket down and fix it with the Flat Head Screws.

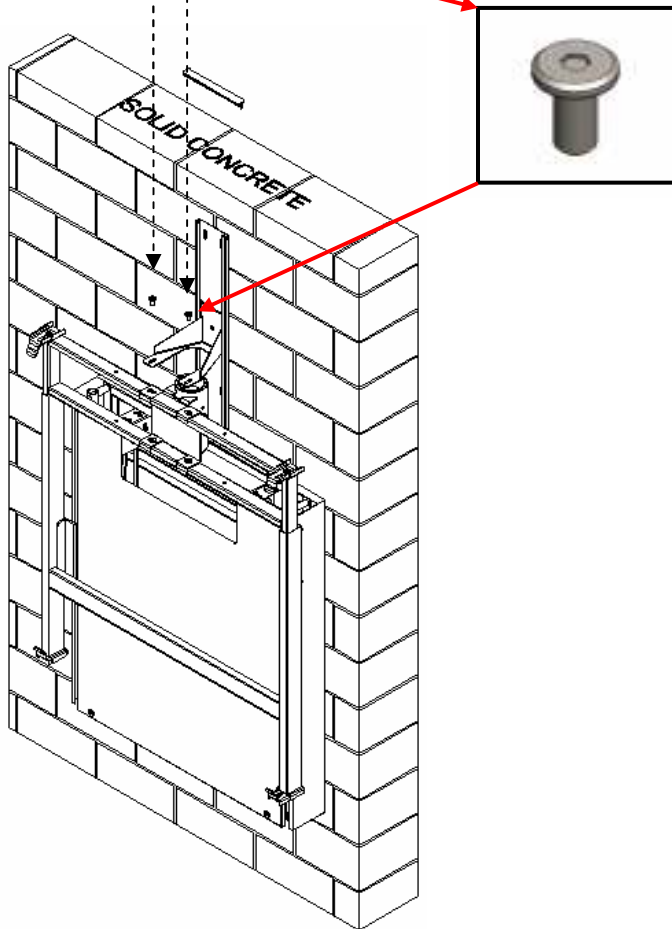

Figure 14.1

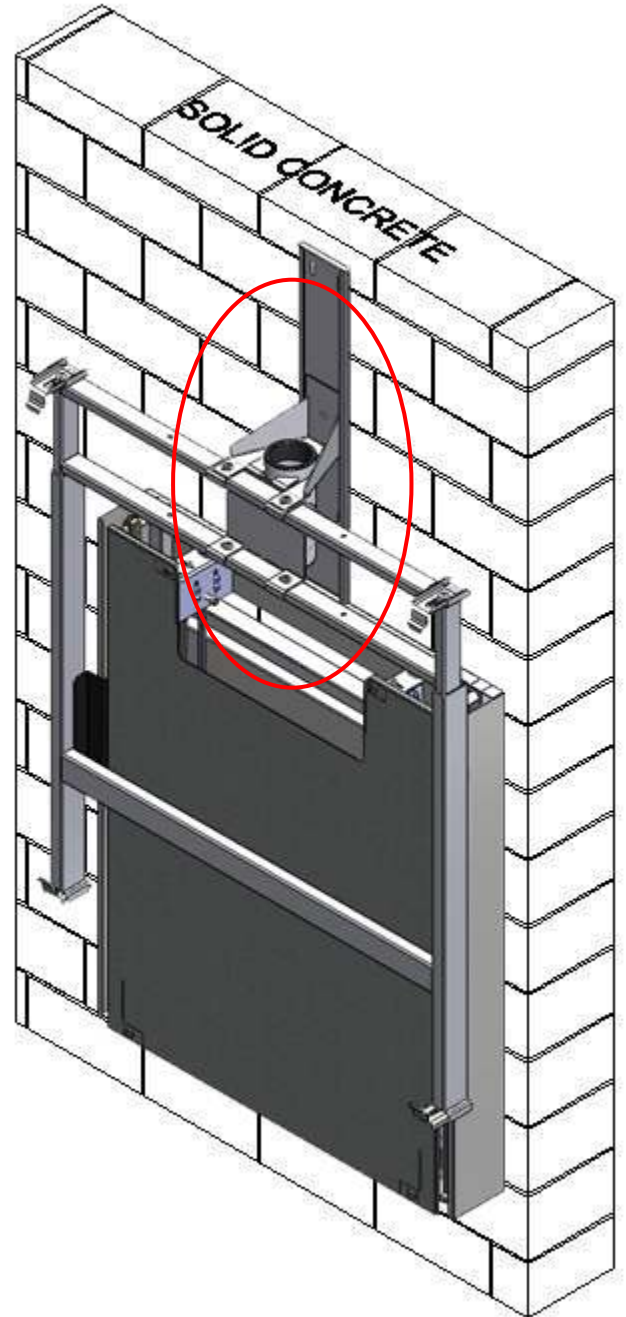

Figure 14.2

- 11) Assembly ready

- 1) Cable wiring start from Top Arm (1). When reached Vertical Tube (2), extend wire length additional 450 mm. The additional wires is used for the front frame rise to the highest level. (see figure 15.2).
- 2) When wires tie down after Vertical Tube (2) (see figure 15.3), choose either direction (3) or (4) to locate the switch. Use cable ties to tight the wires.
- 3) Reinstall the Front cover to the Mid-Section and tighten the four Screws using the Allen Key **(E)** (see figure 7.1).

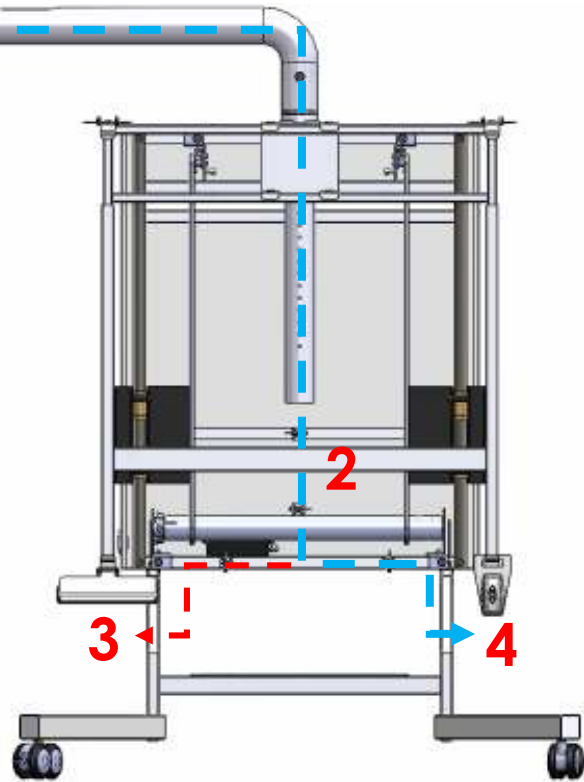

Figure 15.1

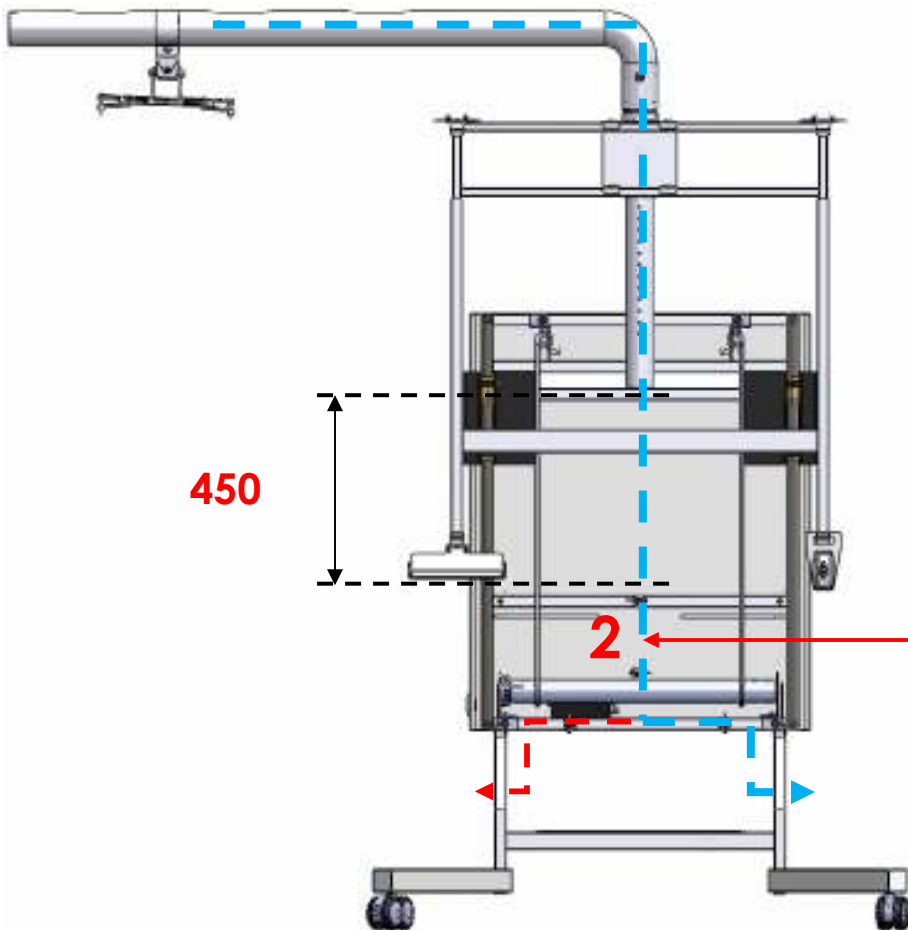

Figure 15.2

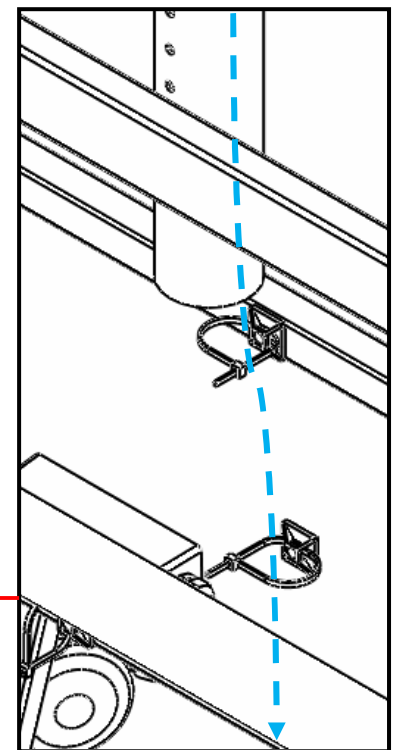

Figure 15.3